

## RCCN 日成PB-LR型右弯分线盒 Pull Box

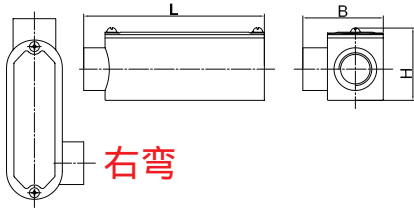
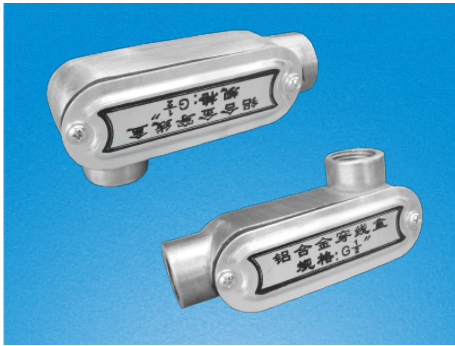

型号 Item No.	螺牙规格 Specification	L mm	B mm	H mm	包装 Packing
PB-LR-G1/2	1/2"	110	47	41	每包 5pcs
PB-LR-G3/4	3/4"	130	60	48	
PB-LR-G1	1"	138	66	52	
PB-LR-G1-1/4	1 1/4"	160	74	66	
PB-LR-G1-1/2	1 1/2"	168	78	70	
PB-LR-G2	2"	230	110	82	
PB-LR-G2-1/2	2 1/2"	242	132	110	
PB-LR-G3	3"	260	145	120	
PB-LR-G4	4"	275	170	140	

产品材质:铝合金制成.

产品特性:1.可直接连接对应外螺纹硬管.

2.配合日成NBG-G接头和MCR软管接线.

Material:Aluminium metal

Features:1.can be connected with outer thread rigid conduit directly

2.usded with RCCN NBG-G connectors amd ,MCR flexible conduit

## RCCN 日成PB-LL型左弯分线盒 Pull Box

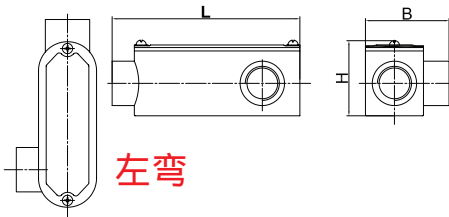

型号 Item No.	螺牙规格 Specification	L mm	B mm	H mm	包装 Packing
PB-LL-G1/2	1/2"	110	47	41	每包 5pcs
PB-LL-G3/4	3/4"	130	60	48	
PB-LL-G1	1"	138	66	52	
PB-LL-G1-1/4	1 1/4"	160	74	66	
PB-LL-G1-1/2	1 1/2"	168	78	70	
PB-LL-G2	2"	230	110	82	
PB-LL-G2-1/2	2 1/2"	242	132	110	
PB-LL-G3	3"	260	145	120	
PB-LL-G4	4"	275	170	140	

产品材质:铝合金制成.

产品特性:1.可直接连接对应外螺纹硬管.

2.配合日成NBG-G接头和MCR软管接线.

Material:Aluminium metal

Features:1.can be connected with outer thread rigid conduit directly

2.usded with RCCN NBG-G connectors amd ,MCR flexible conduit

## RCCN 日成PB-LB型后弯分线盒 Pull Box

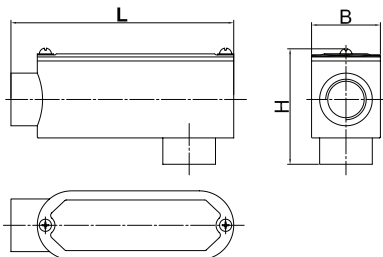

型号 Item No.	螺牙规格 Specification	L mm	B mm	H mm	包装 Packing
PB-LB-G1/2	1/2"	110	34	47	每包 5pcs
PB-LB-G3/4	3/4"	130	38	60	
PB-LB-G1	1"	138	45	74	
PB-LB-G1-1/4	1 1/4"	160	54	75	
PB-LB-G1-1/2	1 1/2"	168	58	85	
PB-LB-G2	2"	230	74	105	
PB-LB-G2-1/2	2 1/2"	240	92	130	
PB-LB-G3	3"	260	108	145	
PB-LB-G4	4"	275	132	170	

产品材质:铝合金制成.

产品特性:1.可直接连接对应外螺纹硬管.

2.配合日成NBG-G接头和MCR软管接线.

Material:Aluminium metal

Features:1.can be connected with outer thread rigid conduit directly

2.usded with RCCN NBG-G connectors amd ,MCR flexible conduit